

ZETA-P 40
ZETA-P 85
ZETA-P 100

max. 44 l/min - 12 GPM • 20 bar - 290 PSI • 550 RPM

max. 85 l/min - 23 GPM • 20 bar - 290 PSI • 550 RPM

max. 98 l/min - 26 GPM • 20 bar - 290 PSI • 550 RPM

TESTATE a base di resina poliester
Polyester resin-based HEADS

DISEGNO ZETA-P 40 E ZETA-P 85: VEDI PAG.10
ZETA-P 40 AND ZETA-P 85 DRAWING: SEE PAGE 10
DISEGNO ZETA-P 100: VEDI PAG.11
ZETA-P 100 DRAWING: SEE PAGE 11



ZETA-P 40
ZETA-P 85



ZETA-P 100

alberi P. di F. disponibili available P.T.O. shaft



1C

2-13

Solo/Only **ZETA-P85 / ZETA-P100**



VA

4-15



TS 1C

1

13

Solo/Only **ZETA-P85 / ZETA-P100**

Per le dimensioni degli Alberi P. di F. vedi pag. 35

For P.T.O. Shaft dimensions see page 35

applicazioni shaft adaptors

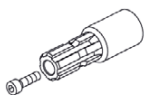

1

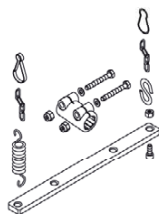

2

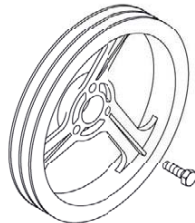

4



13

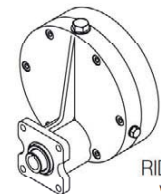

RIDUTTORI **15**
Vedi pag. 42

GEAR REDUCTIONS **15**
See page 42

MOD.	RPM	0 bar / 0 PSI				5 bar / 72 PSI				10 bar / 145 PSI				15 bar / 217 PSI				20 bar / 290 PSI				Peso Weight
		Portata Flow rate		Potenza Power		Portata Flow rate		Potenza Power		Portata Flow rate		Potenza Power		Portata Flow rate		Potenza Power		Portata Flow rate		Potenza Power		
		l/min	GPM	HP	kW	l/min	GPM	HP	kW	l/min	GPM	HP	kW	l/min	GPM	HP	kW	l/min	GPM	HP	kW	
ZETA-P 40	400	33.0	8.7	0.3	0.2	30.0	7.9	0.6	0.4	29.3	7.7	0.8	0.6	28.8	7.6	1.2	0.8	28.5	7.5	1.5	1.1	12
	450	36.5	9.6	0.4	0.3	33.5	8.9	0.7	0.5	32.8	8.7	0.9	0.7	32.3	8.5	1.3	0.9	32.0	8.5	1.7	1.2	
	500	40.2	10.6	0.4	0.3	37.2	9.8	0.7	0.5	36.5	9.6	1.0	0.8	36.0	9.5	1.4	1.1	35.7	9.4	1.9	1.4	
	550	44.0	12.0	0.4	0.3	41.0	10.8	0.8	0.6	40.3	10.6	1.2	0.8	39.8	10.5	1.6	1.2	39.5	10.4	2.1	1.5	
ZETA-P 85	400	62.2	16.4	0.6	0.5	58.6	15.5	1.2	0.9	58.2	15.4	1.7	1.2	57.5	15.2	2.3	1.7	57.3	15.1	3.0	2.2	12
	450	69.7	18.4	0.7	0.5	65.9	17.4	1.3	1.0	65.5	17.3	1.9	1.4	64.9	17.1	2.6	1.9	64.6	17.1	3.4	2.5	
	500	77.2	20.4	0.8	0.6	73.2	19.3	1.5	1.1	72.7	19.2	2.1	1.5	72.2	19.1	2.9	2.1	71.8	19.0	3.8	2.8	
	550	85.0	23.0	0.8	0.6	80.4	21.2	1.6	1.2	79.9	21.1	2.3	1.7	79.4	21.0	3.2	2.3	79.0	20.9	4.2	3.1	
ZETA-P 100	400	72.8	19.2	0.7	0.5	69.2	18.3	1.4	1.0	68.8	18.2	2.0	1.4	68.4	18.1	2.7	2.0	68.2	18.0	3.6	2.6	13
	450	81.6	21.6	0.8	0.6	77.6	20.5	1.6	1.1	77.2	20.4	2.2	1.6	75.5	19.9	3.0	2.2	76.4	20.2	4.0	3.0	
	500	90.4	23.9	0.9	0.7	86.0	22.7	1.7	1.3	85.6	22.6	2.4	1.8	82.5	21.8	3.3	2.4	84.6	22.4	4.5	3.3	
	550	98.0	26.0	1.0	0.7	92.7	24.5	1.9	1.4	92.2	24.4	2.6	1.9	91.7	24.2	3.7	2.7	91.3	24.1	4.8	3.5	